



# Mabel Brown Estate

40.00 Acres, more or less located in the Southwest Quarter of the Southeast Quarter of Section 19 Loraine Township, Henry County, Illinois

Asking Price: \$6,250.00 per acre  
Total Acres: 40.00 Acres  
Tillable Acres: 31.00 FSA Acres  
Taxes: \$679.12



## Soils Map

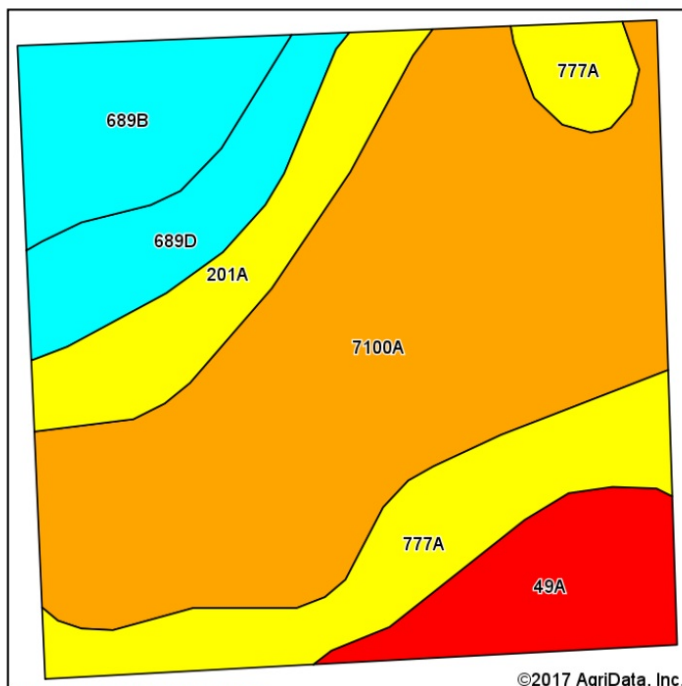

Soils data provided by USDA and NRCS.

©2017 AgriData, Inc.

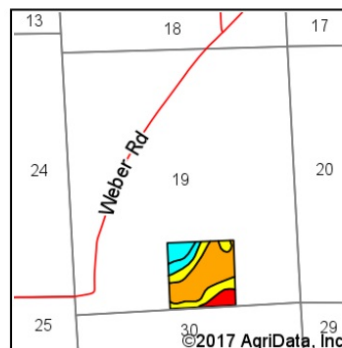

State: **Illinois**  
 County: **Henry**  
 Location: **19-18N-4E**  
 Township: **Loraine**  
 Acres: **40.01**  
 Date: **3/7/2017**

Maps Provided By



© AgriData, Inc. 2017



Area Symbol: IL073, Soil Area Version: 12

Code	Soil Description	Acres	Percent of field	Il. State Productivity Index Legend	Subsoil rooting <sup>a</sup>	Corn Bu/A	Soybeans Bu/A	Crop productivity index for optimum management
7100A	Palms muck, 0 to 2 percent slopes, rarely flooded	19.55	48.9%		FAV	161	51	118
777A	Adrian muck, 0 to 2 percent slopes	6.19	15.5%		FAV	146	49	110
201A	Gilford fine sandy loam, 0 to 2 percent slopes	3.76	9.4%		FAV	148	49	110
**689B	Coloma sand, 1 to 7 percent slopes	3.73	9.3%		FAV	**101	**32	**75
49A	Watsika loamy fine sand, 0 to 2 percent slopes	3.59	9.0%		FAV	122	41	93
**689D	Coloma sand, 7 to 15 percent slopes	3.19	8.0%		FAV	**95	**30	**71
<b>Weighted Average</b>						<b>143.1</b>	<b>46.2</b>	<b>106</b>

Area Symbol: IL073, Soil Area Version: 12

**Table: Optimum Crop Productivity Ratings for Illinois Soil by K.R. Olson and J.M. Lang, Office of Research, ACES, University of Illinois at Champaign-Urbana.** Version: 1/2/2012 Amended Table S2 B811

Crop yields and productivity indices for optimum management (B811) are maintained at the following NRES web site:

<https://www.ideals.illinois.edu/handle/2142/1027/>

\*\* Indexes adjusted for slope and erosion according to Bulletin 811 Table S3

<sup>a</sup> UNF = unfavorable; FAV = favorable

Soils data provided by USDA and NRCS. Soils data provided by University of Illinois at Champaign-Urbana.

\*c: Using Capabilities Class Dominant Condition Aggregation Method

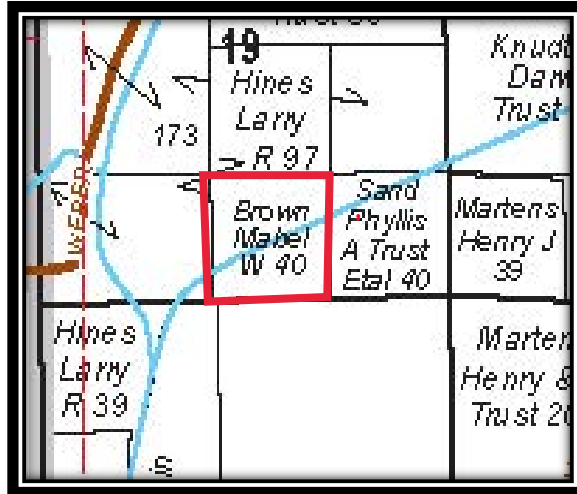

Reprinted with permission from 2014 Rockford Map Publishing, INC.